

VL 132

Prestazioni motori 4 poli – Servizio S1 – Protezione IP23S

Performances motors 4 poles - Duty S1 – Protection IP23S

| | Velocità nominale Nominal speed | Potenza nominale Nominal power | Coppia nominale Nominal torque | Tensione nominale Nominal voltage | Corrente nominale Nominal current | Coppia massima Maximum torque | Velocità massima a potenza costante Maximum speed at constant power | Velocità meccanica massima Maximum mechanical speed | Inerzia rotore Rotor inertia | Peso Weight |
|----------|------------------------------------|-----------------------------------|-----------------------------------|--------------------------------------|--------------------------------------|----------------------------------|--|--|---------------------------------|----------------|
| Type | nn rpm | Pn kW | Tn Nm | Vn V | In A | Tmax Nm | np rpm | nmax rpm | J kgm ² | Kg |
| VL 132 S | 1000 | 16 | 153 | 400 | 33 | 244 | 1200 | 7000 | 0,067 | 132 |
| | 1500 | 23 | 146 | | 45 | 233 | 1900 | | | |
| | 2000 | 30 | 142 | | 57 | 227 | 2300 | | | |
| | 2500 | 36 | 138 | | 70 | 220 | 3700 | | | |
| | 3000 | 42 | 134 | | 79 | 215 | 3600 | | | |
| VL 132 M | 1000 | 22 | 210 | 400 | 45 | 336 | 1700 | 7000 | 0,086 | 157 |
| | 1500 | 31 | 197 | | 59 | 315 | 2000 | | | |
| | 2000 | 39 | 182 | | 75 | 290 | 2600 | | | |
| | 2500 | 43 | 168 | | 83 | 268 | 3100 | | | |
| | 3000 | 49 | 156 | | 93 | 249 | 3900 | | | |
| VL 132 L | 1000 | 24 | 229 | 400 | 49 | 366 | 1600 | 7000 | 0,098 | 175 |
| | 1500 | 34 | 216 | | 67 | 345 | 2200 | | | |
| | 2000 | 42 | 190 | | 81 | 304 | 2700 | | | |
| | 2500 | 47 | 180 | | 92 | 288 | 4100 | | | |
| | 3000 | 50 | 168 | | 97 | 268 | 4000 | | | |
| VL 132 P | 1000 | 28 | 267 | 400 | 56 | 427 | 1600 | 7000 | 0,120 | 200 |
| | 1500 | 39 | 248 | | 77 | 396 | 2700 | | | |
| | 2000 | 48 | 218 | | 92 | 348 | 2600 | | | |
| | 2500 | 54 | 198 | | 105 | 316 | 4400 | | | |
| | 3000 | 57 | 181 | | 112 | 289 | 4500 | | | |
| VL 132 X | 1000 | 29 | 277 | 400 | 59 | 443 | 1700 | 7000 | 0,126 | 220 |
| | 1500 | 42 | 267 | | 81 | 427 | 1900 | | | |
| | 2000 | 50 | 239 | | 98 | 382 | 3800 | | | |
| | 2500 | 57 | 209 | | 114 | 334 | 5600 | | | |
| | 3000 | 60 | 191 | | 125 | 305 | 7000 | | | |

Dimensioni di ingombro VL 132 - IP 23S

Overall dimensions VL 132 - IP 23S

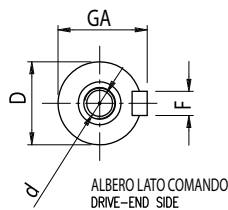
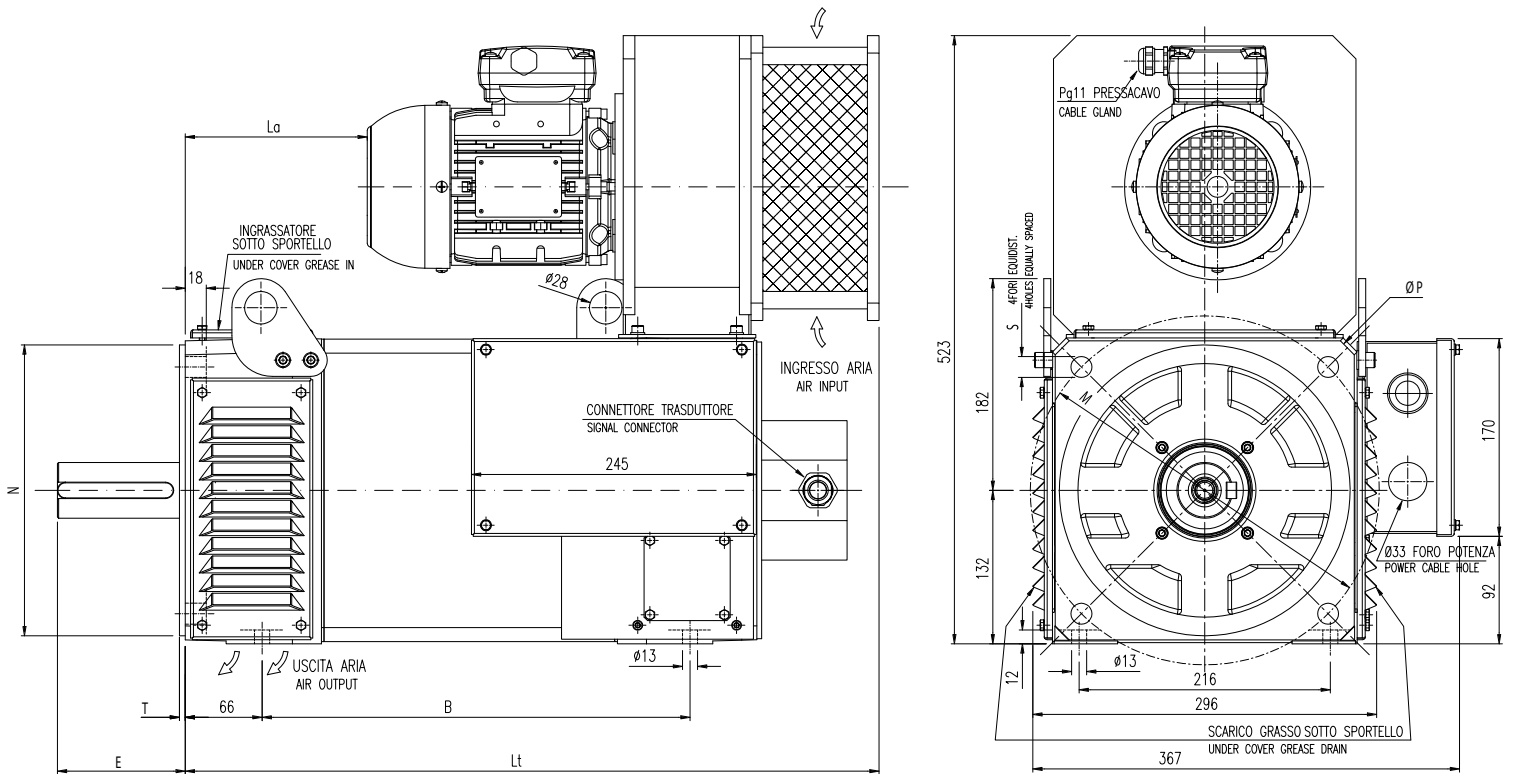

| Tipo Type | Lunghezza Length | | | Albero Shaft | | | | | Flangia Front flange | | | | |
|--------------|---------------------|-----|-----|-----------------|-----|------|----|-----|-------------------------|-----|---|-----|----|
| | B | La | Lt | D | E | GA | F | d | P | N | T | M | S |
| VL 132 | S | 308 | 96 | 48k6 | 110 | 51,5 | 14 | M16 | 350 | 250 | 5 | 300 | 18 |
| | M | 368 | 156 | | | | | | | | | | |
| | L | 408 | 196 | | | | | | | | | | |
| | P | 473 | 263 | | | | | | | | | | |
| | X | 518 | 306 | | | | | | | | | | |

Motori con freno: vedere lunghezza aggiuntiva tabella freni

Motors with brake: see additional length on the brake table